

NOTES:

1. Contractor shall notify the Water Utility Inspector at least one (1) week prior to construction. Phone: (714) 765-4591.
2. A separate Right-of-Way Construction permit is required for all work within the public right-of-way. Contact the Engineering representative at the Public Works Department front counter or call (714) 765-5176 to obtain information.
3. All contractors working on any portion of the City of Anaheim, Public Utilities Water System shall possess a current valid "C-34"(Pipeline Contractor) or an "A"(General Engineering Contractor) license.
4. Use _____ PSI static water pressure to derive thrust block bearing surface area per Water Standard W-140 and W-142.
5. All work shall be in accordance with the latest version of the City of Anaheim, Water Services Standard Specifications (WSSS).
6. Onsite plumbing/sprinkler plan for firelines shall be approved by Anaheim Fire Department prior to the approval of this drawing.
7. All above ground large water services and backflow devices shall be screened from view with appropriate landscaping per the applicable sections of the WSSS. The concrete pad shall be located behind the building setback line.
8. All large meters (greater than 2-inch) shall be compound meters unless otherwise approved by Water Engineering.
9. All unused water facilities shall be abandoned at the water main as directed by the Water Utility Inspector. For small services 2-inch or less, the corporation stop shall be closed and restrained to the main prior to any abandonment. The service line shall be cut and plugged, the meter and meter box shall be removed, and the meter shall be returned to the Water Utility Inspector. For large services greater than 2-inch, the service line shall be cut and plugged, the valve and valve box removed, and the tee branch shall be blind flanged, MJ capped, or plugged and further restrained with a thrust block per the WSSS. The meter shall be removed and returned to the Water Utility Inspector. The water vaults and/or surface concrete of the abandoned service(s) shall be removed and the surface improvements shall be restored as directed by the Water Utility Inspector.
10. A plumbing permit is required from the City of Anaheim Building Division for any new, altered or repaired plumbing system on private property. The Building Division is located on the 1st floor of City Hall, 200 S. Anaheim Blvd. Phone: (714) 765-5153.
11. Maintain 12-inch minimum vertical separation between water laterals and any other utilities.

12. The Developer/Contractor is responsible for verifying, in the field, the exact location, size, and type of all existing water facilities. The Utility is not responsible for the accuracy of any Utility records of drawings pertaining to existing water facilities.
13. The Contractor shall pothole all the utility crossings prior to the beginning of construction. The Contractor shall also field verify the exact location, size, depth, and type of all existing utilities and interferences situated along the route of proposed construction prior to commencement of excavation, fabrication, and installation. Contractor shall, at his own expense and cost, construct all improvements in such a manner as will protect all existing underground utilities and, in the event of conflicts, shall notify the Engineer.
14. All domestic backflow prevention devices shall be lead-free compliant with the State of California Health and Safety Code 116875.
15. All stainless steel tapping sleeves 12-inch diameter and less shall be rated for 250 PSI working pressure. Approved models are Mueller (model H-304SS), Powerseal (model 3490 AS), and Ford (model FTSS) No Equals.
16. Trench replacement shall comply with City of Anaheim Public Works Standard Detail No. 132.

CONSTRUCTION NOTES:

- ① HOT TAP W/ 8"x4" TAPPING SLEEVE AND 4" TAPPING VALVE PER CITY STD. W-201
- ② INSTALL 2" IRRIGATION WATER SERVICE, 2" METER AND BOX WITH 2" REDUCED PRESSURE BFPA PER CITY STD. W-102 & W-104 BEHIND BUILDING SETBACK LINE
- ③ INSTALL 1" DOMESTIC WATER SERVICE AND 1" METER AND BOX PER CITY STD. W-101
- ④ INSTALL 4" DIP CLASS 52 WATER LATERAL PER CITY STD. W-201
- ⑤ INSTALL THRUST BLOCK PER CITY STD. W-140
- ⑥ INSTALL 4" ABOVE GROUND FIRE LINE AND DCDA PER CITY STD. W-207 & W-220 BEHIND BUILDING SETBACK LINE
- ⑦ REMOVE EXISTING METER BOX
- ⑧ ABANDON 4" FIRE SERVICE, REMOVE VALVE AND REMAINDER OF 4" FIRE LINE LATERAL. ADD BLIND FLANGE AT TEE. REMOVE VAULT, IF APPLICABLE
- ⑨ CUT & PLUG EXISTING WATER SERVICE AT THE MAIN. CLOSE CORPORATION STOP. SALVAGE METER TO WATER INSPECTOR



SAMPLE ONLY



Underground Service Alert

of Southern California

Call TOLL FREE
1-800-227-2600

TWO WORKING DAYS BEFORE YOU DIG

PUBLIC WORKS

APPROVED - CITY ENGINEER _____ DATE _____

PUBLIC UTILITIES DEPARTMENT

REVIEWED - WATER INSPECTION _____ DATE _____

REVIEWED - CROSS CONNECTION _____ DATE _____

APPROVED - WATER ENGINEERING _____ DATE _____

AS-BUILT _____ DATE _____

PLANNING DEPARTMENT

REVIEWED _____ DATE _____

FIRE DEPARTMENT

(ACKNOWLEDGEMENT OF ON-SITE
FIRELINE/SPRINKLER SYSTEM APPROVAL) _____ DATE _____

CITY OF ANAHEIM

U. W. M.

PROJECT ADDRESS / LOCATION
(NUMBER, TYPE, AND SIZE OF SERVICES)

SHEET 1 OF 2

W.O. NO.	
ENG. TASK	01
INSP. TASK	02
DIST. NO.	

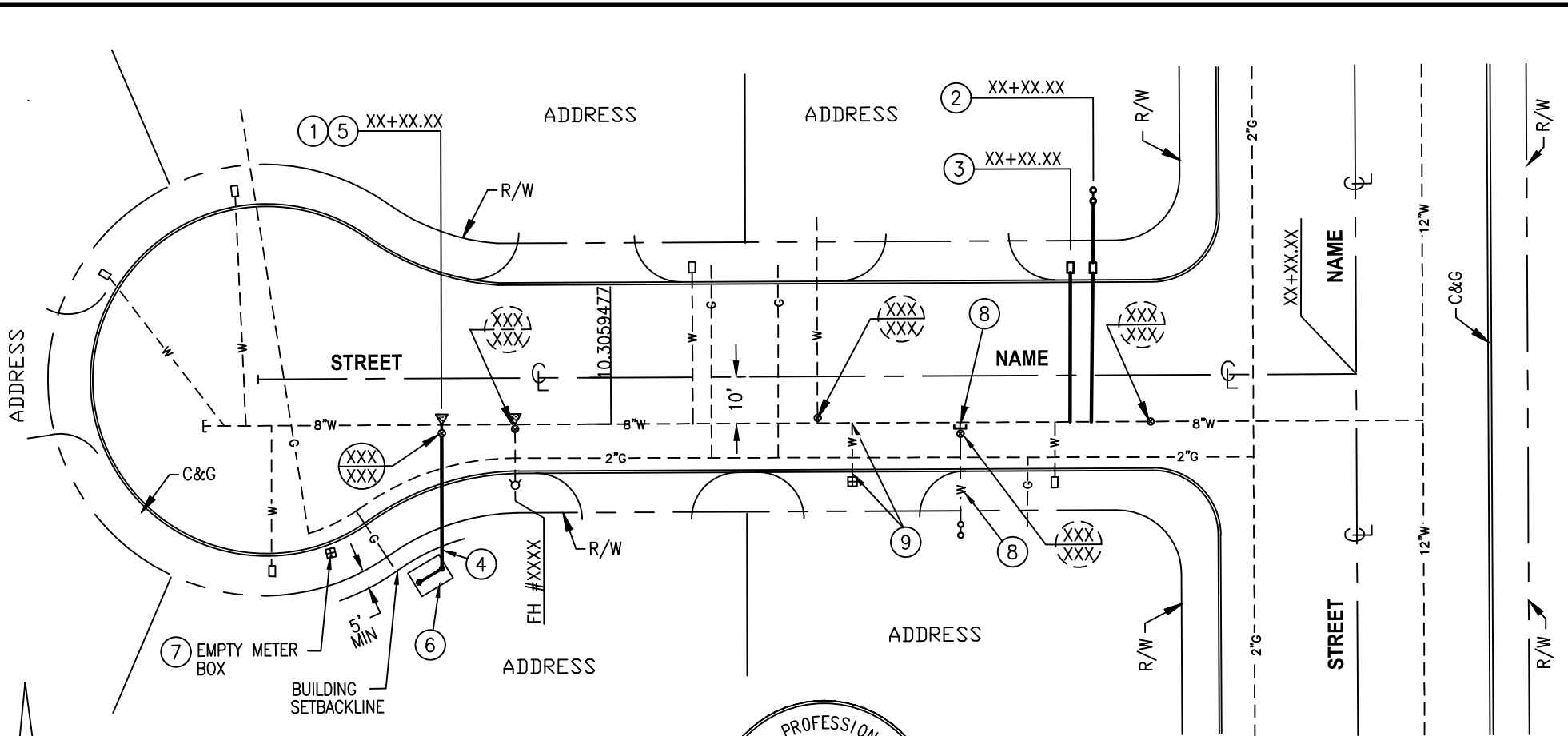

 SCALE
 1"=20'



Underground
 Service Alert
 of Southern California
 Call TOLL FREE
 1-800-227-2600
 TWO WORKING DAYS BEFORE YOU DIG

SAMPLE ONLY

PUBLIC UTILITIES DEPARTMENT			
APPROVED - WATER ENGINEERING		DATE	
AS-BUILT		DATE	
FIRE HYDRANT NO.			
MAKE			

VALVE NO.	MAKE	SIZE	TURNS	DEPTH

CITY OF ANAHEIM
PROJECT ADDRESS / LOCATION (NUMBER, TYPE, AND SIZE OF SERVICES)

U. W. M.	
SHEET 1 OF 2	
W.O. NO.	
ENG. TASK	01
INSP. TASK	02
DIST. NO.	